

# File resource

A resource is an item that a teacher can use to support learning, such as a file or link. e-Course System supports a range of resource types which teachers can add to their courses. In edit mode, a teacher can add resources via the 'Add an activity or resource' link. Resources appear as a single link with an icon in front of it that represents the type of resource.

Different file types are shown with different icons as below:

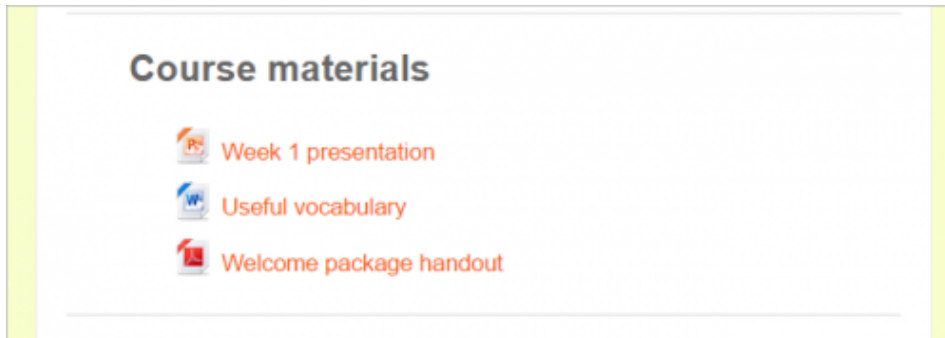

*Files displayed on a course page*

Files may be added by uploading from an external source such as computer or USB drive, or by dragging and dropping directly onto the course page. Both options need the editing to be turned on.

To drag and drop a file, click and hold the file (*1 below*), drag it to your chosen section (*2*), and release. The file will upload and display (*3*):

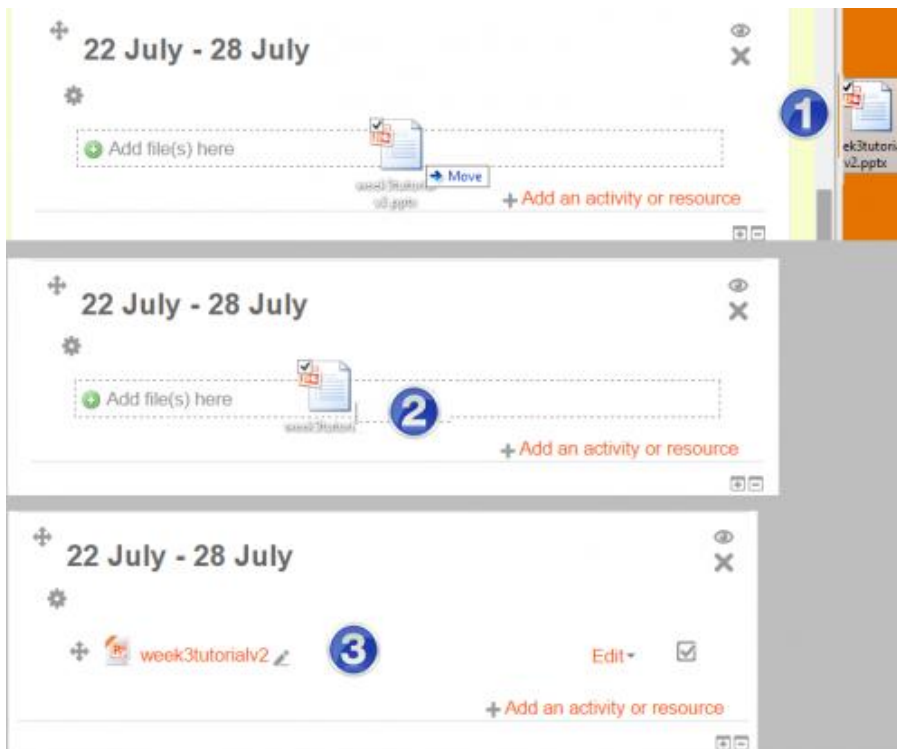

*File drag and drop*

**Note:** How students will view your file will depend on the type of file and its display settings.

[More about file >>](#)